OWNER'S MANUAL

HPC500 Series Top Running and Underhung End Trucks

½ Ton, 1 Ton, and 2 Ton Capacity

Code and Serial No.

⚠ WARNING

This equipment should not be installed, operated or maintained by any person who has not read and understood all the contents of this manual. Failure to read and comply with the contents of this manual can result in serious bodily injury or death, and/or property damage.

HARRINGTON
HOISTS AND CRANES

Table 10-1 Parts List for HPC500 Series End Trucks

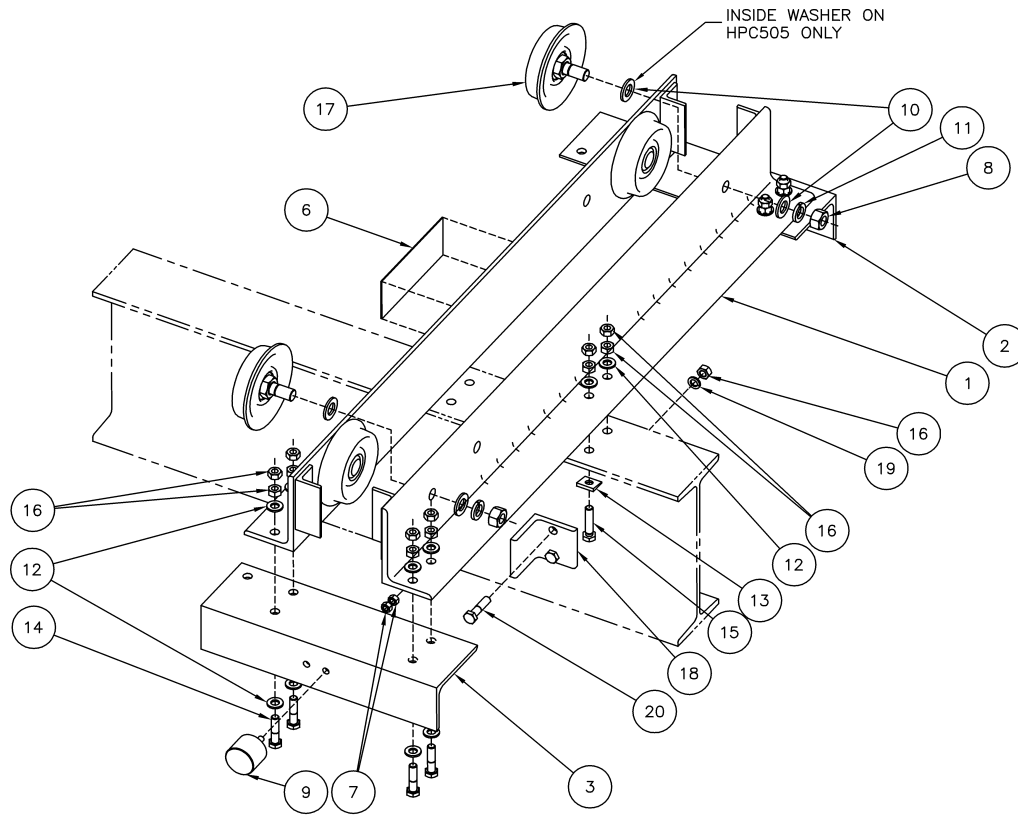

Figure Number	Qty/Pr	HPC505	HPC510	HPC520	PART NAME
1	4	52391	52390	62674	Frame Assembly
2	2		62675		End Bracket A – Standard Flange Range
			62678		End Bracket A – Extended Flange Range
3	2		62676		End Bracket B – Standard Flange Range
			62679		End Bracket B – Extended Flange Range
6	2	80065	80066	80067	Name Plate
7	8		9003903		Nut
8	8	9003905	9003908		Nut
9	4		9004603		Bumper
10	16	9005209			Flat Washer
	8		9005212		
11	8	9005313	9005317		Lock Washer
12	40		9012515		Flat Washer
13	8		9043514		Tapered Washer
14	16		9093374		Bolt
15	8		9093376		Bolt
16	52		9093433		Nut
17	8	9200011	9200012	9200013	Wheel Assembly
18	4		6245909		End Stop
19	4		9012713		Spring Washer
20	4		9093146		Bolt